

BILL OF MATERIAL						
MARK	QTY.	DESCRIPTION	LENGTH	MATERIAL	WEIGHT	WEIGHT TOTAL
28B2008	1	BEAM				
28B2008	1	W18X35	30'-4 7/8"	A992	1066	1066
	10	7/8 Ø A325N	0'-2"			
TOTAL	1	TOTAL THIS BOM ONLY=				1066

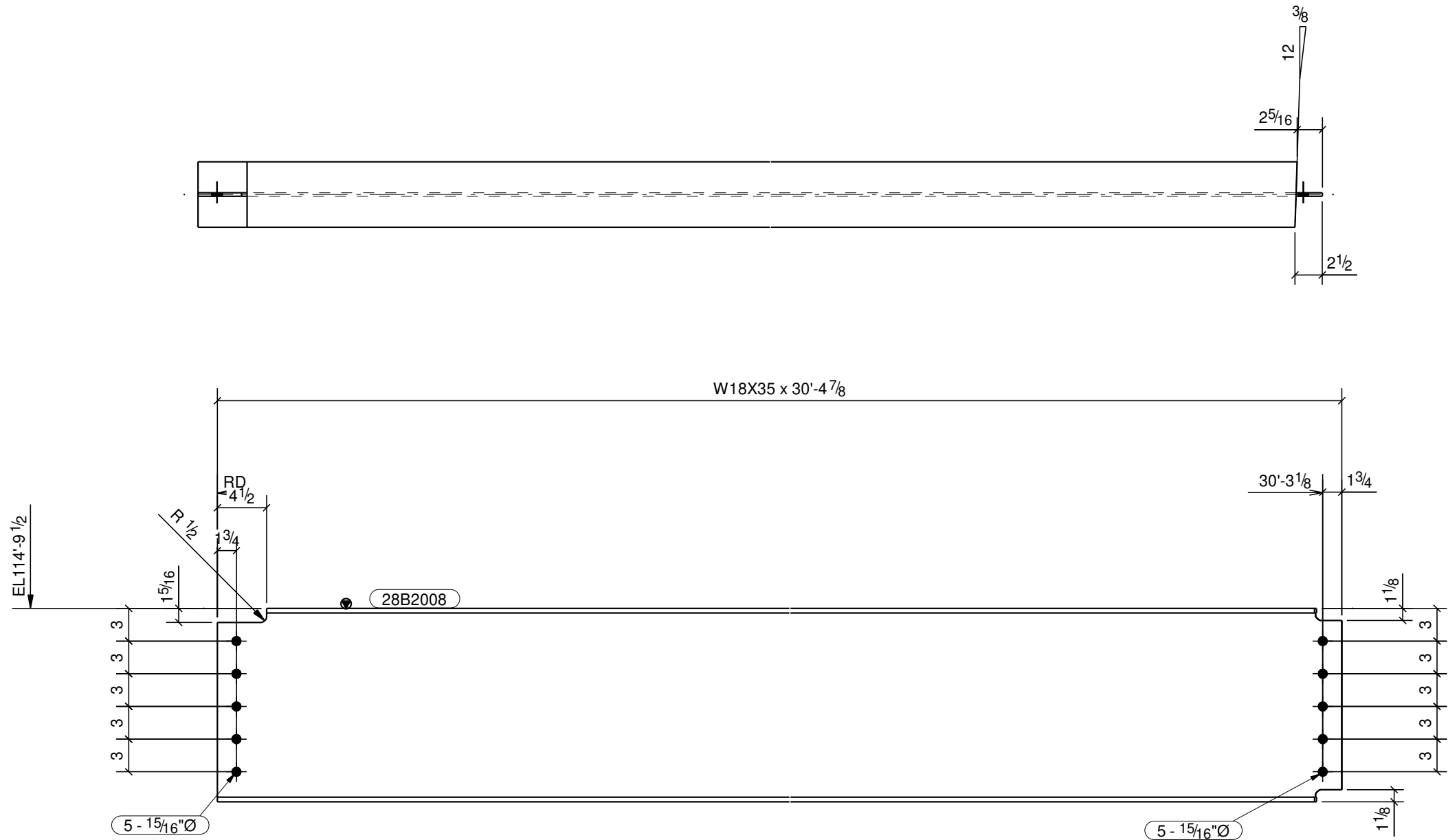

Fit	_____	Date	_____	Insp	_____	Date	_____
Weld	_____	Date	_____	Insp	_____	Date	_____
Final	_____	Date	_____				

0	11/14/2022	ISSUED FOR FABRICATION
A	07/09/2022	ISSUED FOR APPROVAL
REV.	DATE	DESCRIPTION

- SHOP NOTES
- BEAMS AND COLUMNS THAT BECOME BENT OR DISTORTED DURING SHIPPING,HANDLING, PUNCHING,WELDING,ETC.MUST BE STRAIGHTENED.
  - PIECE MARK LEFT END AS DETAILED ON NEAR SIDE OF MEMBER
  - COLUMN PIECE MARK IS TO APPEAR ON THE BOTTOM OF THE BASE AND ON THE SAME COLUMN FACE AS THE DIRECTION MARK NEAR THE COLUMN BASE.
  - ⊗ INDICATE PAINT STRIPE SIDE. MARK ⊗ AREA ADJACENT TO CONNECTION FOR FIELD USE.
  - RD" INDICATE RUNNING DIMENSIONS TO THIS POINT
  - AII FULL PENETRATION WELDS SHALL BE UT TESTED IN ACCORDANCE WITH AWS D1.1. UNLESS DIRECTED OTHERWISE BY CONTRACT SPECIFICATIONS.
  - WELDING TO CONFORM TO AWS SPECIFICATIONS. ELECTRODES: E70XX - LOW HYDROGEN DEBURR ALL HOLES U.N.O.

DWG. TITLE :	BEAM
PROJECT:	DESERET PEAK HIGH SCHOOL
LOCATION:	TOOELE, UT
SHOP BOLTS :	A325N
OPEN HOLES :	13/16 Ø HOLES
CLEAN :	SSPC-SP2
SHOP BOLTS:	3/4 Ø UNO
FINISH:	ONE COAT OF LIGHT GRAY SHOP PRIMER
U.N.O.	
U.N.O.	
U.N.O.	

APPROVAL/REVIEW AUTHORITY:  
PLEASE REVIEW THIS DRAWING CAREFULLY.  
IT REPRESENTS OUR INTERPRETATION OF THE INTENT OF THE CONTRACT DOCUMENTS. HOWEVER, THE STEEL FABRICATOR AND THE STRUCTURAL STEEL DETAILER ASSUME NO RESPONSIBILITY FOR THE ACCURACY OF THE INFORMATION SHOWN ON THE CONTRACT DOCUMENTS AND/OR ARCHITECTURAL AND STRUCTURAL DESIGN DRAWINGS THIS IS THE RESPONSIBILITY OF THE BUYER UNLESS NOTED TO THE CONTRARY ON THIS DRAWING. WHEN IT IS RETURNED FROM APPROVAL IT WILL BE ASSUMED THAT ALL INFORMATION SHOWN HEREIN HAS THE AFFIRMATION OF THE APPROVAL/REVIEW AUTHORITY. SUBSEQUENT CHANGES TO INFORMATION SHOWN ON THESE DRAWINGS AFTER SUBMISSION WILL BE CONSIDERED AS CONTRACT CHANGES



GOS'S WELDING,INC.

P.O. BOX 3010,OGDEN,UTAH 84409  
TEL (801) 392-9611 FAX (801) 392-0425

DRAWN BY :	AMY	DATE :	06/20/2022
CHECKED BY :	SK	DATE :	06/20/2022
JOB NO.	2022-100	DRAWING NO.	28B2008
REF. ERECTION DWGS :			

NOTE:  
ALL COPE CUT ARE AT RADIUS 1/2

ONE - BEAM - 28B2008

CAMBER:			
FIELD STUD			
QTY.	DIA.	LENGTH	GRADE
16			
NOTE:			